

Comfort Series

FRONT VIEW SUBMITTAL DATA © 2002

SIDE VIEW

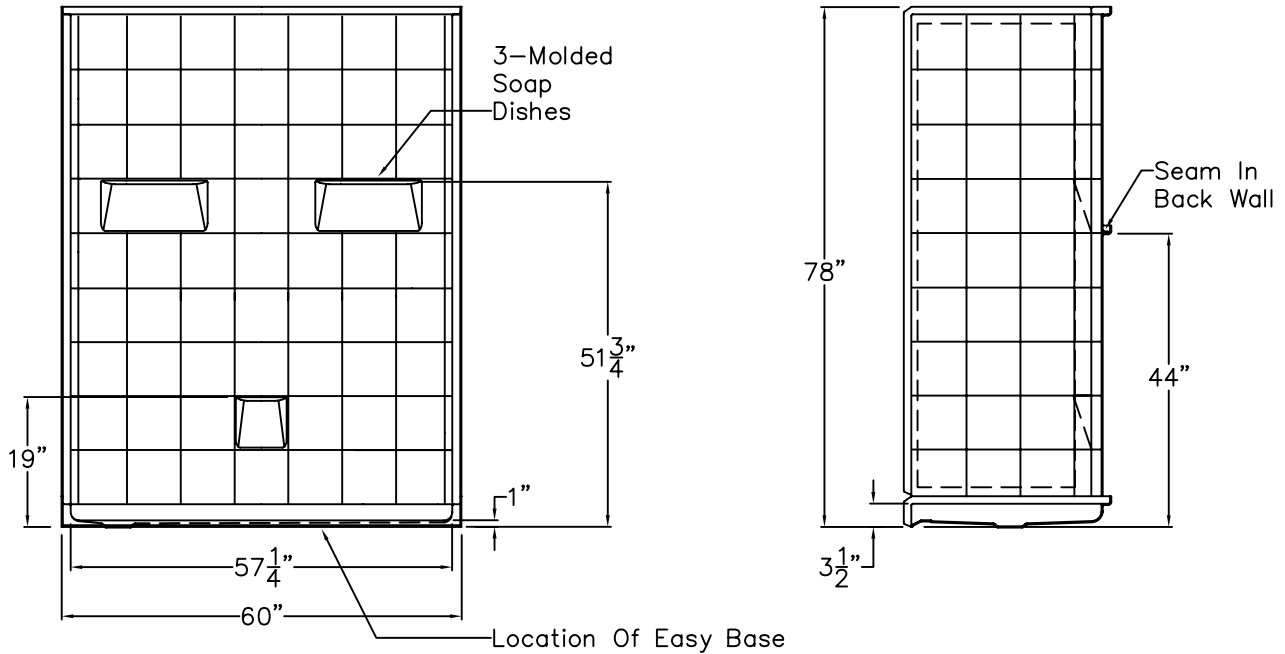

Barrier Free Sectional Shower Stall

The shower enclosure shall be MP 6030 BF 1.0 Five Piece, Right or Left Drain. Finished surface shall be of a sanitary-grade polyester Gelcoat exhibiting a minimal thickness of 15 dry mils, and a finished cured Barcol hardness of 80-90 as tested with ASTM D-2583. Unit construction shall be of molded reinforced fiberglass with a 15% minimum fiberglass content. The unit shall have outside dimensions of 60" x 31" x 78". The five piece unit shall meet ANSI Z124.2, NAHB, UPC, and shall meet the requirements of Southern Building Code.

The enclosure shall be equipped with the following installed accessories:
 1) 1.0" Threshold, 2) Tile Finish, 3) Two Piece Back Wall, 4) Three Molded Soap Dishes on Back Wall, 5) Left hand drain location, 6) Full wood backing on walls, 7) Easy Base self-sustaining bottom.

ALSO AVAILABLE IN RIGHT HAND OR CENTER DRAIN VERSION.

TOP VIEW

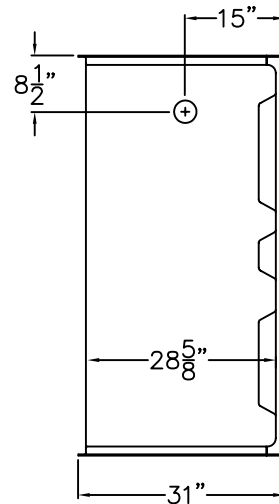

Detail of 1.0" Threshold

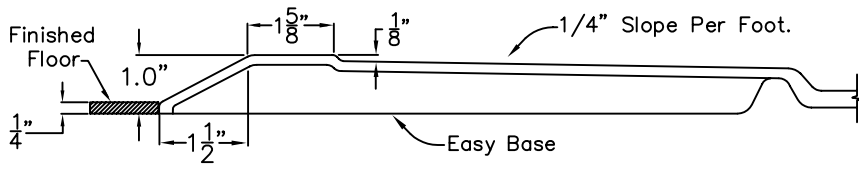

DUE TO THE NATURE OF THE MATERIALS INVOLVED
 UNIT DIMENSIONS MAY VARY ± 1/2 INCH

HAMILTON

Model No.:

Drawing#: MP 6030 BF 5P 1.0 FWB
 Left or Right Drain Easy Base

Approved by:

Date Approved:

Date: 3-31-09

Revised: 4-28-10

Rep.:

Wholesaler:

Quote No.

PRAXIS INDUSTRIES, INC.
 ROUTE 1, BOX 46D - SAVANNAH, TN 38372
 1 (800) 443-7269 - FAX (901) 925-4290

Recyclable Paper

Board Placement Drawing

SUBMITTAL DATA © 2004

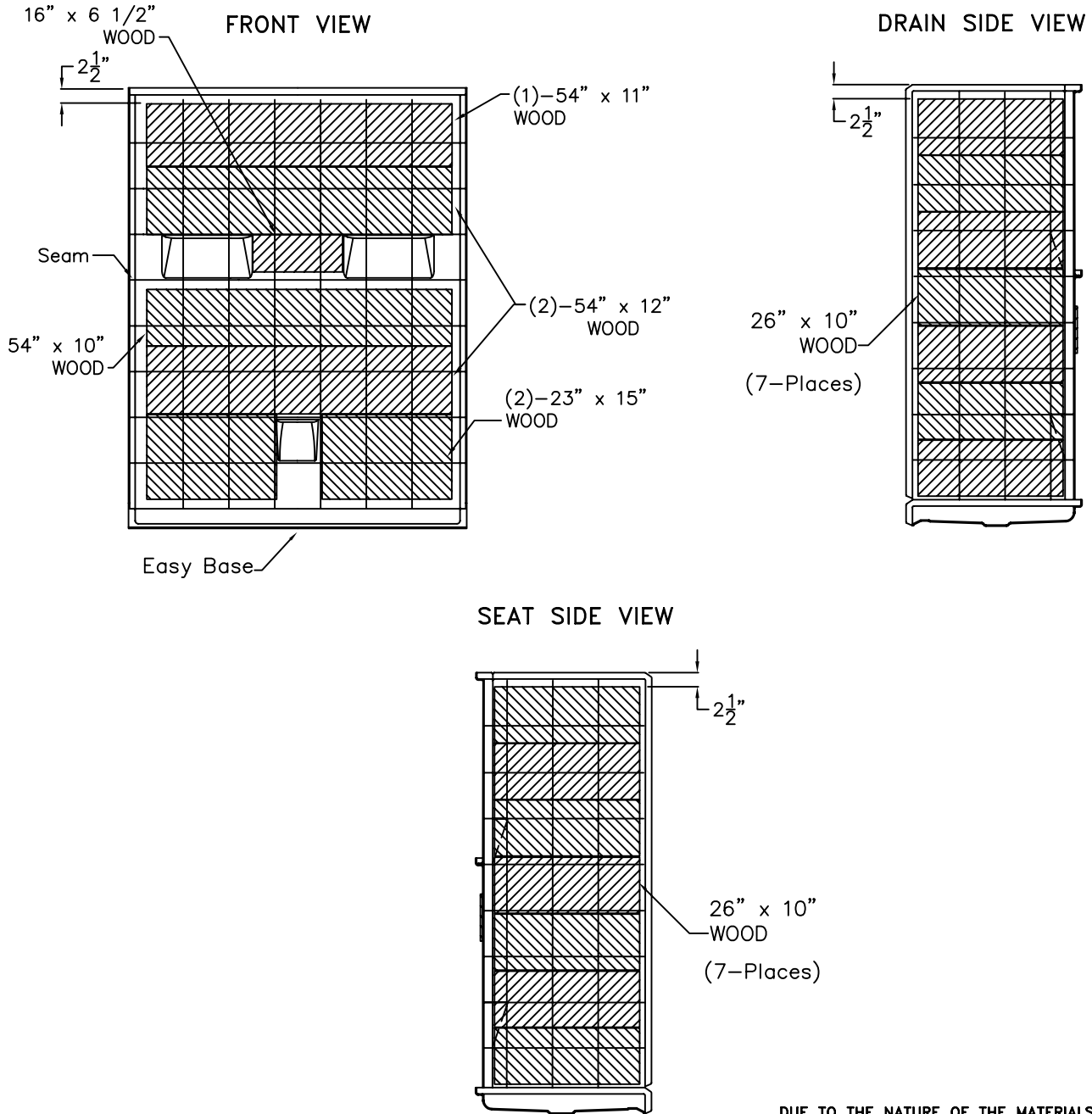

DUE TO THE NATURE OF THE MATERIALS INVOLVED
UNIT DIMENSIONS MAY VARY ± 1/2 INCH

Job Name:		HAMILTON	
Model No.:		Drawing#: MP 6030 BF 5P 1.0 FWB Left or Right Drain Easy Base-BP	
Approved by:	Date Approved:	Date: 12-21-09	Revised: 4-28-10
Rep.:	Wholesaler:	Quote No.:	

PRAXIS INDUSTRIES, INC.
ROUTE 1, BOX 46D - SAVANNAH, TN 38372
1 (800) 443-7269 - FAX (901) 925-4290