

3802-30 – ‘Monarque’ Towel Bar

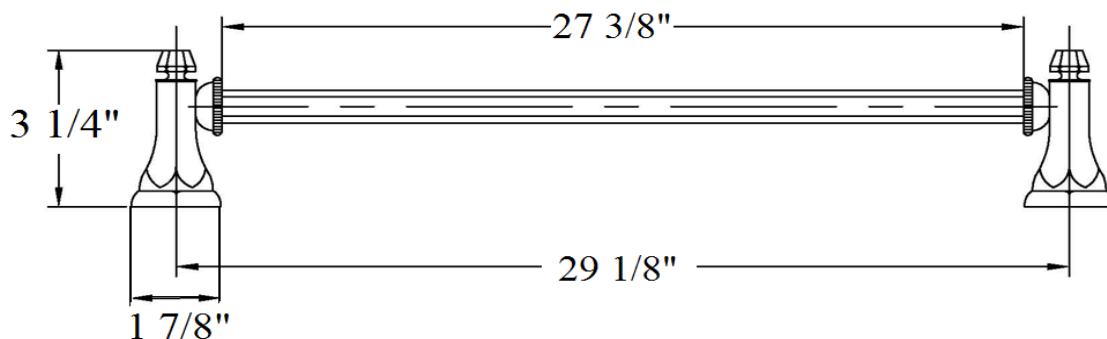

Technical Information

- Bar **cannot** be cut down to length.
- Available finishes are French Weathered Brass (47), Polished Chrome (48), SoliBrass (49), Lacquered Matte Black Nickel (50), Old Gold (52), Old Silver (53), Polished Brass (55), Polished Nickel (56), Brushed Nickel (57), Satin Nickel (60), Antique Lacquered Copper (67), Antique Lacquered Brass (68), Weathered Brass (70), Lacquered Polished Black Nickel (71) and Lacquered Polished Copper (80).
- Please See Cleaning Instructions: <http://herbeau.com/CleaningAll.pdf> For Finish Care and Maintenance Information.

Part#

Description

- | | |
|----|-----------------------|
| 01 | Finished Screw |
| 02 | Monarque Wall Support |
| 03 | Monarque Connector |
| 04 | Monarque Button |
| 05 | 30" Length Bar |

Please follow example when ordering parts for ‘Monarque’ Towel Bar

- To order part#02 – Monarque Wall Support
 - 990425xx
- Please substitute finish number needed in place of xx



Herbeau
L'Art du Sanitaire depuis 1857

3802-30 - 'Monarque' Towel Bar

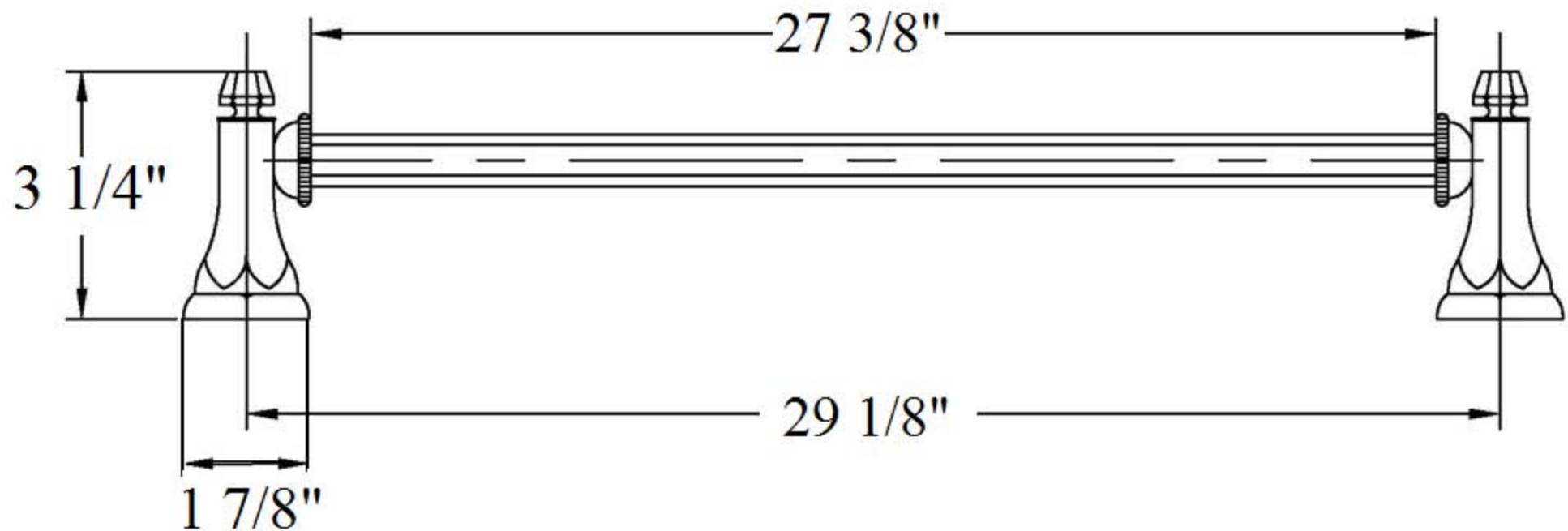

3802-30 - 'Monarque' Towel Bar

*P/N = PART NUMBER

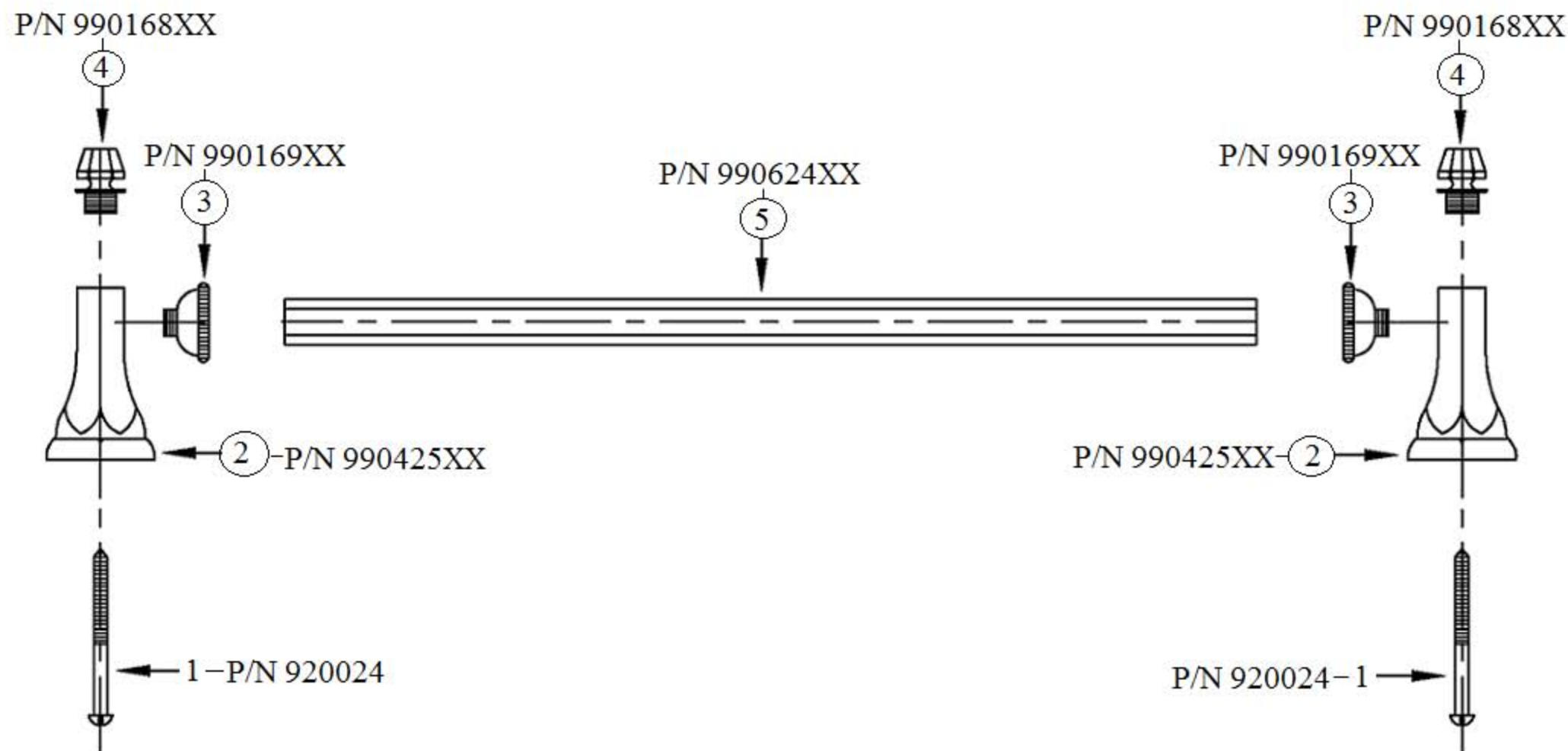

○ = FINISHED PARTS
XX = TWO DIGIT FINISH CODE