



**PIONEER INDUSTRIES, INC.**  
3325 S. Garfield Ave.  
Commerce, CA 90040  
(800) 338-9468  
www.pioneerind.com

# INSTALLATION

## Tools:



Adjustable Wrench



Silicone Sealant



Teflon Tape



Rags

## Model Number: 6MT410

### Warnings and Notes:

Check with local plumbing code requirements before installation.  
This product should be installed by a local listed plumber.  
**Do not use plumbers putty on threads.**



### Installation Steps:

Handheld Shower Set

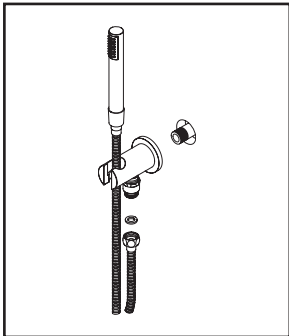

(1) Apply Teflon tape to the pipe nipple stretching out from the wall, attach drop ell with handheld support to pipe nipple. Install vacuum breaker to drop ell. Connect 60" stainless steel hose to vacuum breaker. Use silicone sealant to caulk around drop ell to create water tight seal. Turn on water and check for any leaks. Turn off water and connect handheld showerhead to 60' stainless steel hose.

## Exploded Drawing :

\* Note: Please specify finish/color when ordering.

	ITEM #	DESCRIPTION
A	X-4900112*	1.75 GPM Handheld Showerhead
B	X-4600006*	60" SST Hose
C	X-4600005*	Vacuum Breaker
D	X-4600031*	Drop Ell with Handheld Support
E	X-4600032*	Escutcheon
1	OP-460025	Washer

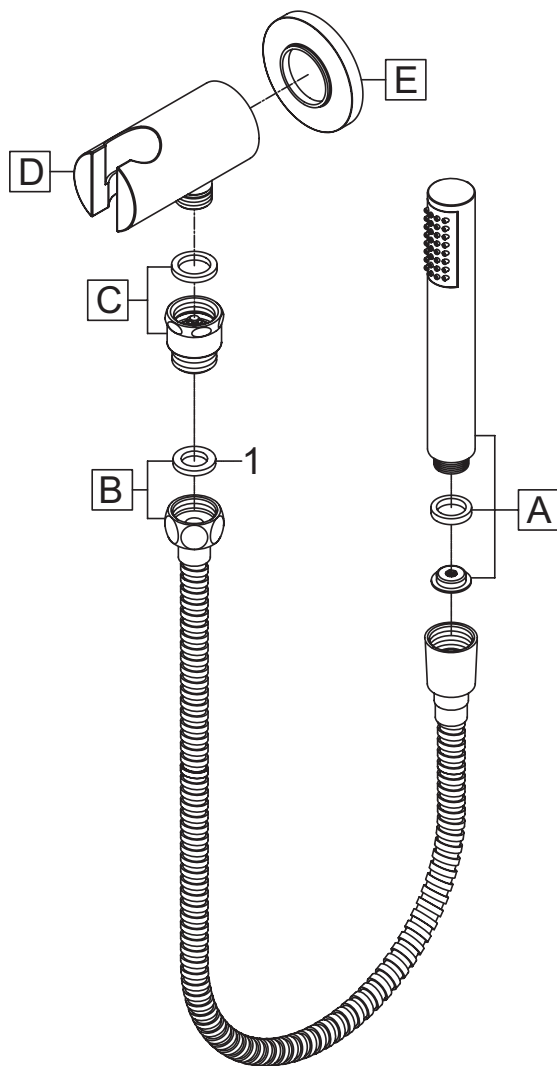

For more care information or trouble shooting inquiries  
 about your Pioneer product, please call:  
**Pioneer Industries, Inc.** (800) 338-9468  
 Monday-Friday 8 AM to 8 PM EST (5 AM to 5 PM PST)  
[www.pioneerind.com](http://www.pioneerind.com)